

Giorgione

HOOD

Pre-installation and installation manual

KGR4
KGR6
KGR6L
KGR9



This hood has been designed and constructed with the utmost care and undergone rigorous tests in our laboratories and for this reason we guarantee its absolute safety and functionality.

The installation must be carried out by **professionally qualified** staff, that can take responsibility for the installation and guarantee the best safe operating conditions.

Before the installation, read the content of this manual **carefully**: it contains important information regarding product assembly and safety regulations.

Technical service

The Dealer can solve any technical problem regarding installation. Do not hesitate to contact him in case of doubt.

CUPPONE 1963
Cuppone F.lli S.r.l.
Via Sile, 36
31057 Silea (TV) - ITALY
T +39 0422 361143
F +39 0422 360993
info@cuppone.com - www.cuppone.com

The company cannot be held liable for any print or transcription errors, reserving the right to make changes where deemed suitable without prior notice.

Partial reproduction without the Manufacturer's consent is prohibited. Measurements are purely indicative and not binding.

The original language used to prepare this manual is English: the Manufacturer is not responsible for any translation/interpretation or print errors.

1	CHECKS BEFORE PURCHASING	3
2	TECHNICAL DATA.....	5
	Giorgione KGR435 hood technical data hood + single oven.....	5
	Giorgione KGR435 hood technical data hood + double oven.....	6
	Giorgione KGR635 hood technical data hood + single oven.....	7
	Giorgione KGR635 hood technical data hood + double oven.....	8
	Giorgione KGR635L hood technical data hood + single oven.....	9
	Giorgione KGR635L hood technical data hood + double oven.....	10
	Giorgione KGR935 hood technical data hood + single oven.....	11
	Giorgione KGR935 hood technical data hood + double oven.....	12
3	INSTALLATION.....	13
	Symbols.....	13
	Transport	14
	Preliminary operations.....	14
	Assembling the hood.....	14
	Positioning and connection to the oven below.....	18
	Serial number plate reading	19
	Smoke extraction.....	20
	Pre-testing and final inspection.....	21

1 CHECKS BEFORE PURCHASING

Before purchasing the hood and installing it, check the following conditions, necessary for the correct installation, operation and maintenance of the hood.

A	Transport (Owner's inspection)
✓	Make sure that, on the day when you receive the hood or it is installed:
	<ul style="list-style-type: none"> lifting equipment is available that can handle the appliance safely (check weight and dimensions in the following pages), together with staff qualified to carry out this operation; personal protection equipment is available (e.g. safety shoes, gloves, etc.)

B	Installation room (Owner's inspection)
✓	Make sure that:
	<ul style="list-style-type: none"> the floor of the installation room is fireproof, perfectly flat and capable of withstanding the weight of the hood and underlying oven. the installation room: <ul style="list-style-type: none"> is dedicated and suitable to cooking food; has adequate air ventilation; complies with the current regulations on health and safety and systems in the workplace; is protected from the weather; has a maximum temperature of between +5° (41°F) and +35°C (95°F); has a maximum humidity of 70%.

- **Fig. 2** there is a distance of about **600 mm [24"]** from the ceiling (shorter distances could damage ceilings made of particularly delicate and heat sensitive materials - e.g. wood);
- there is adequate ventilation according to the regulations in force in the Country of installation.

 When choosing the positioning room, take into account that the appliance must be easy **to move** for any extraordinary maintenance: be careful that any brickwork after installation (e.g.: wall construction, replacement of a door with a narrower one, renovations, etc.) do not hamper movements.

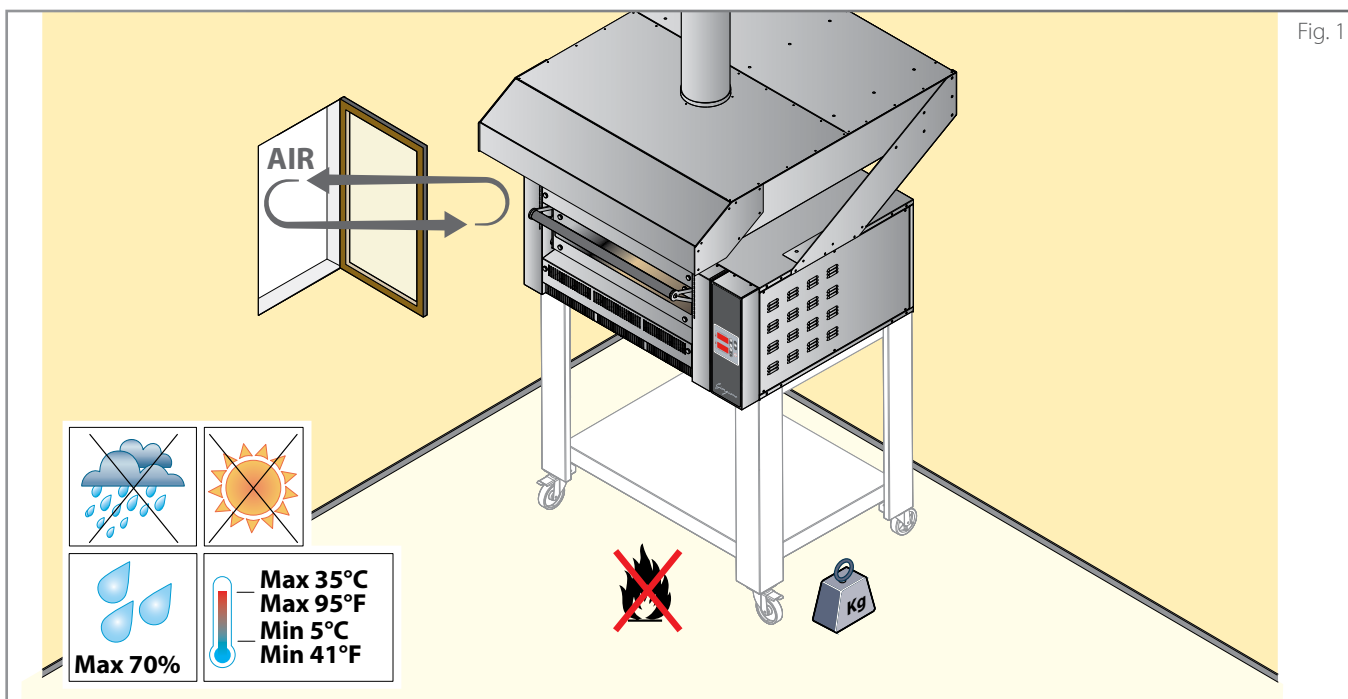

Fig. 1

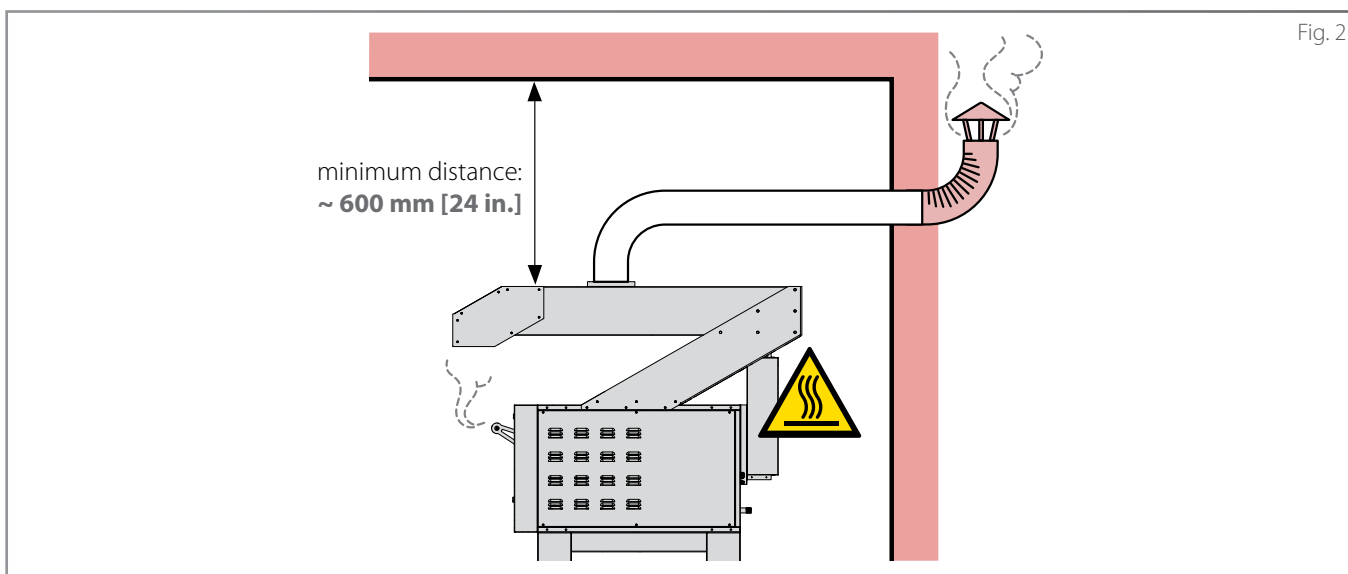

Fig. 2

Checks before purchasing

C Check with an inspection how to eliminate the fumes and gases of the oven

✓ Make sure that

► **Fig. 3** and **Fig. 4**

The oven is fitted with a flue in the back to get rid of the steam from the cooking chamber and the flue gas. The gas from the cooking chamber and from the door opening can be conveyed outside through the manufacturer's hood (under-hood type).

Using metal clamps (not supplied), connect to it a Ø200mm [Ø7.87in.] flue tube (not supplied). The flue tube must be for the exclusive use of the equipment, in stainless steel resistant to high temperatures and must comply with current regulations.

The hood is not equipped with a suction motor, however it is possible to connect it to a **suitable user suction system** (the extractor, the flue tube and the clamps are NOT supplied by the manufacturer).

UNDER-HOOD TYPE

hose and clamps
not supplied

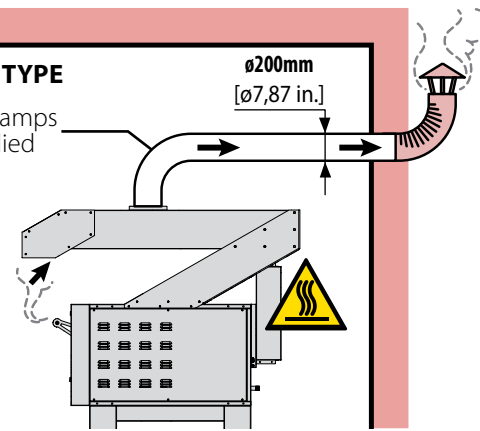

hose and clamps
not supplied

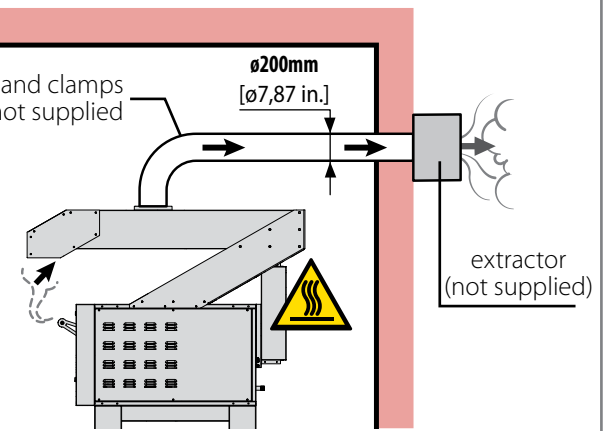

Fig. 3

flue tube (A)
and metal clamps (B)
not supplied by the Manufacturer

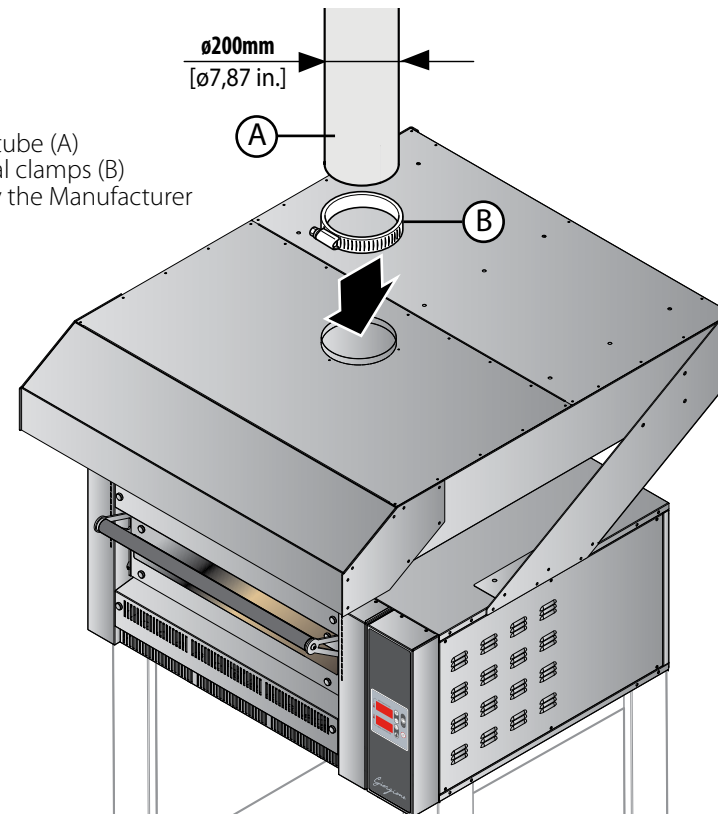
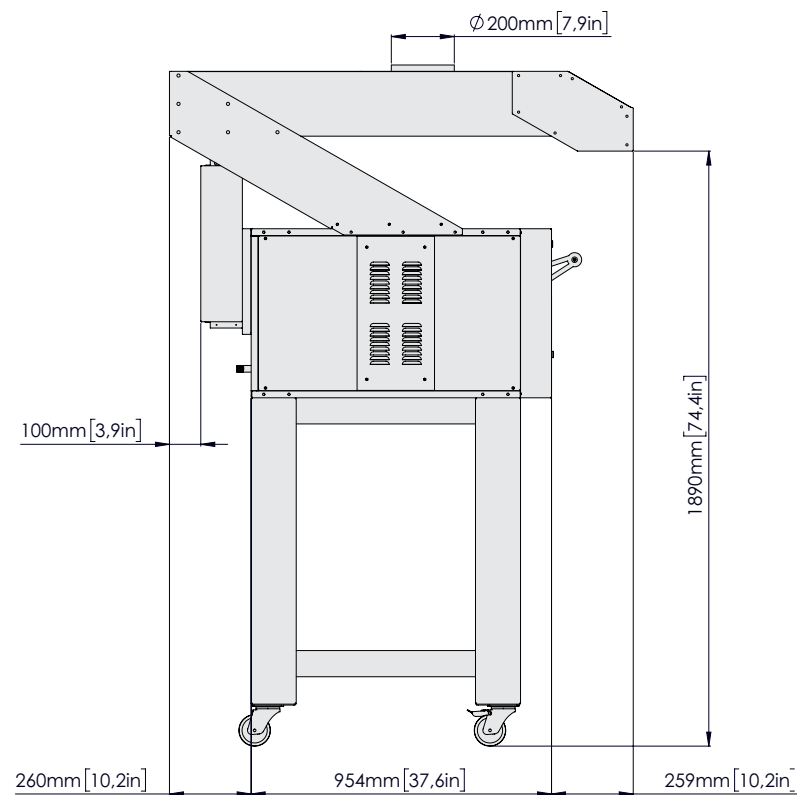
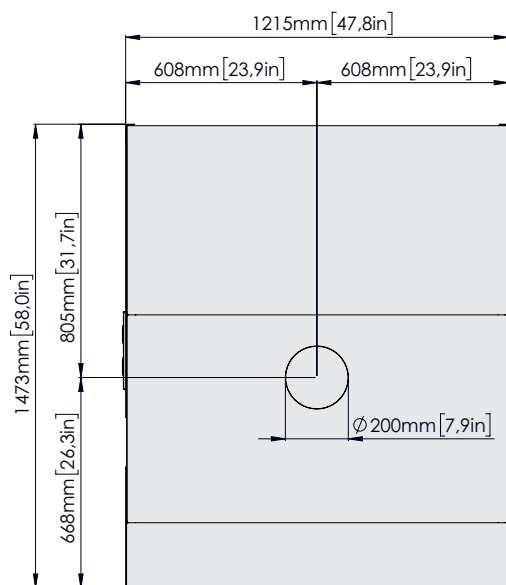
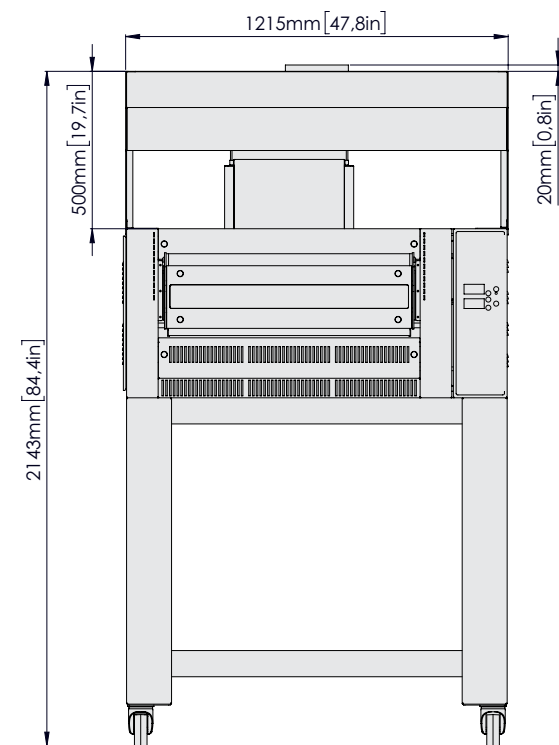



Fig. 4

2 Giorgione KGR435 hood technical data | hood + single oven



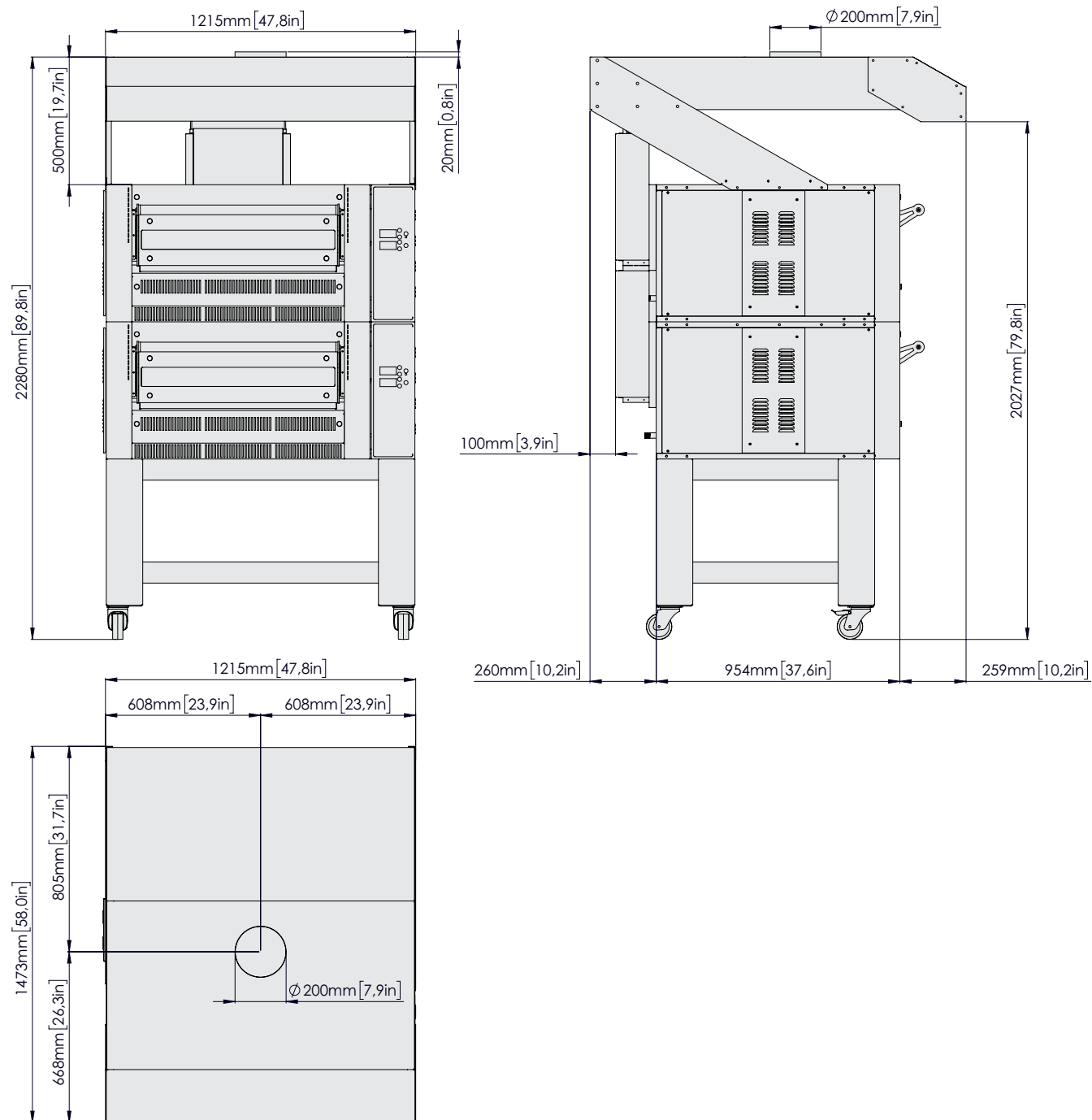

	model	
	KGR435	62 kg [136.6 lb]
	KGR435	1320x1370x420 mm [51.97x53.94x16.54 in.] 140 kg [308.6 lb]

Giorgione KGR435 hood technical data | hood + double oven

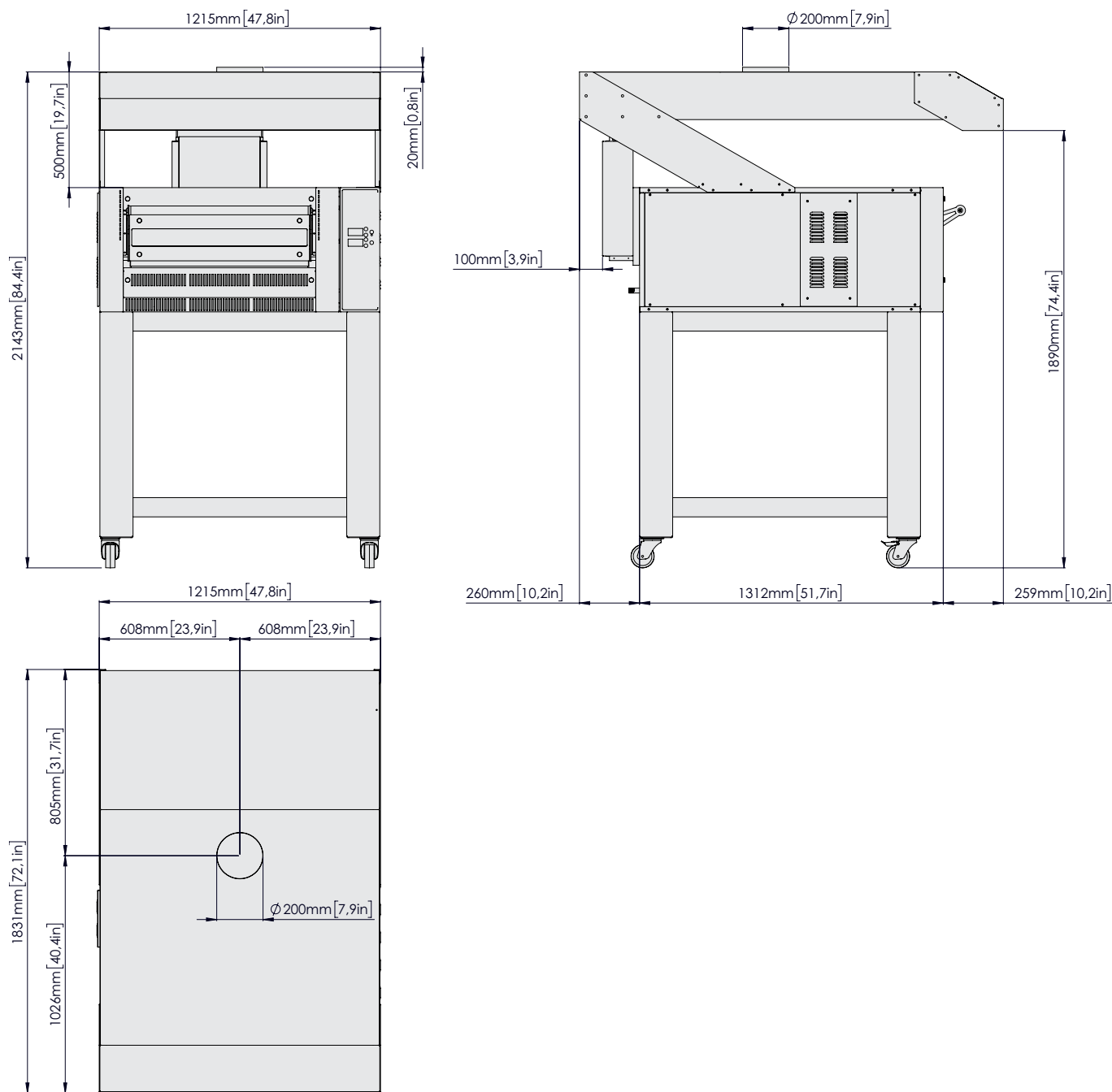

Giorgione KGR635 hood technical data | hood + single oven

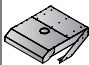

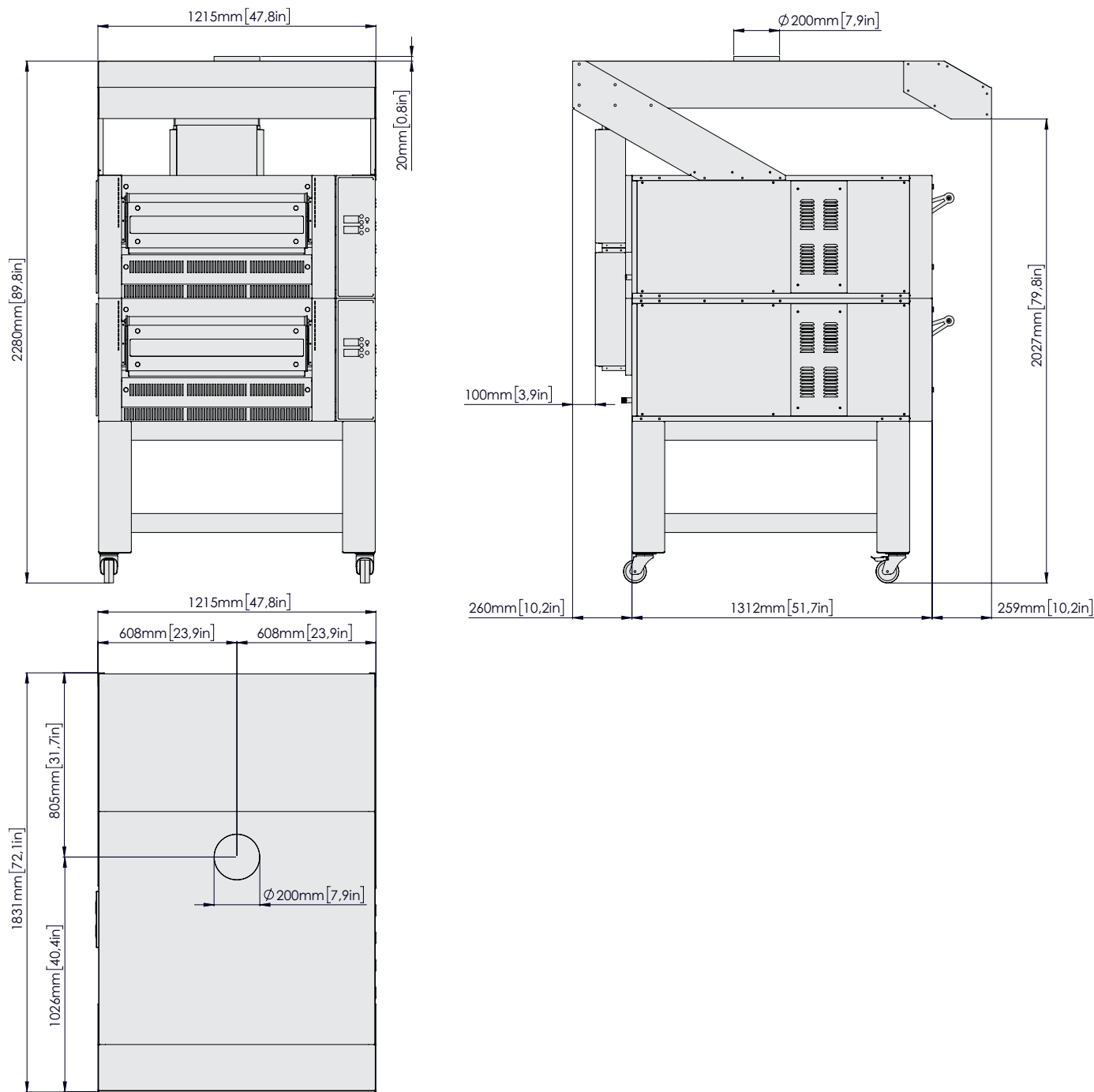

model		
	KGR635	67 kg [147.7 lb]
	KGR635	1320x1730x420 mm [51.97x68.11x16.54 in.] 158 kg [348.3 lb]

Giorgione KGR635 hood technical data | hood + double oven

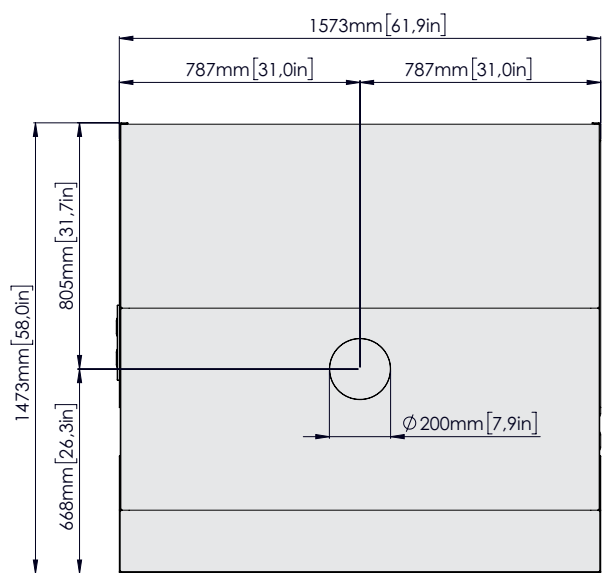
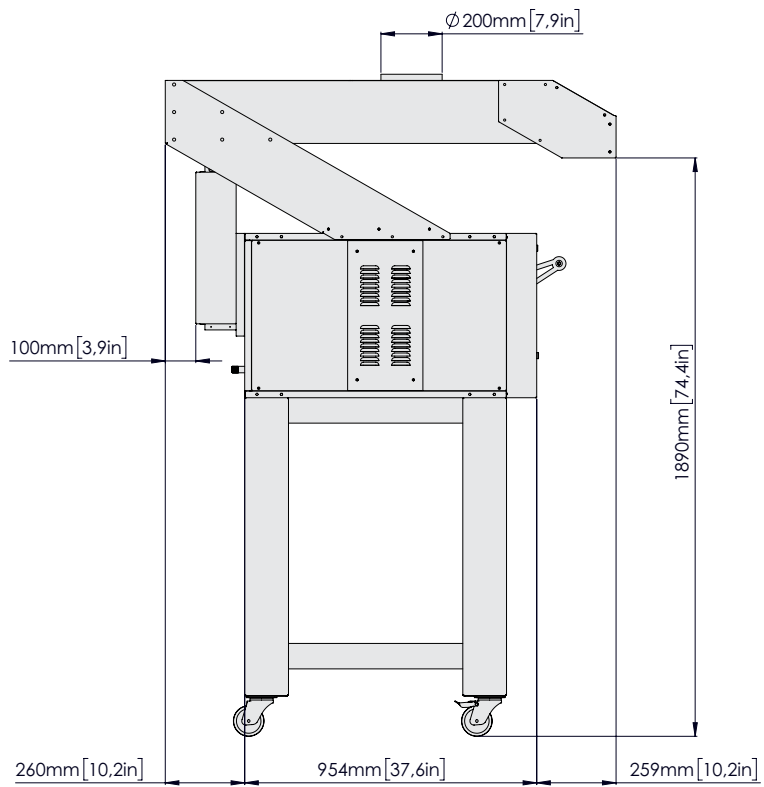
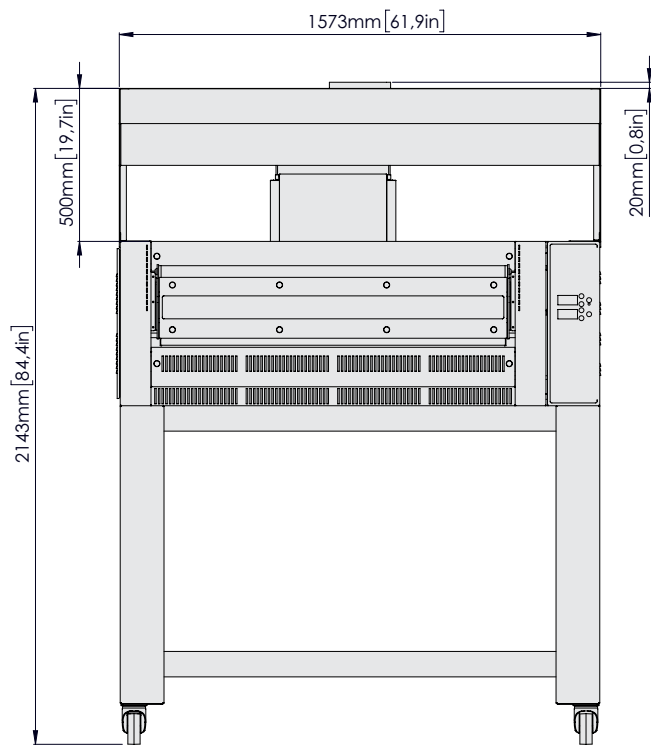

Giorgione KGR635L hood technical data | hood + single oven



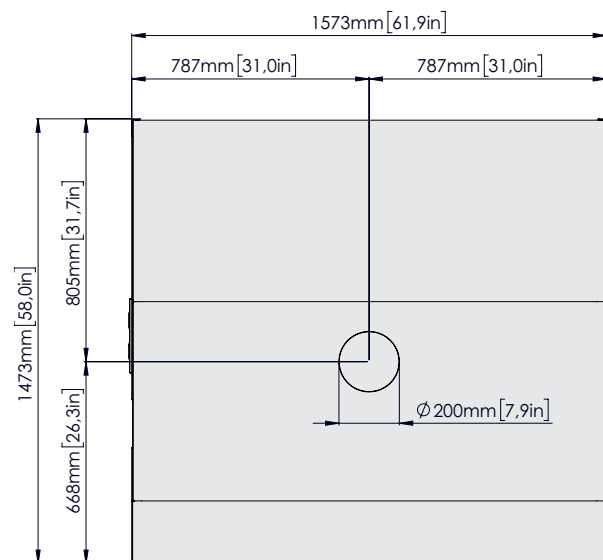
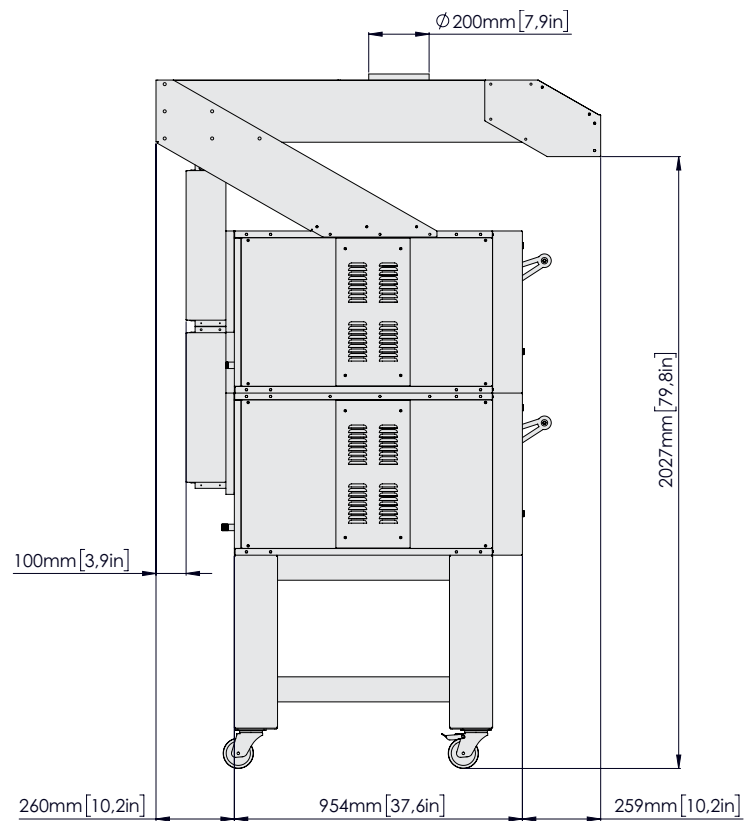
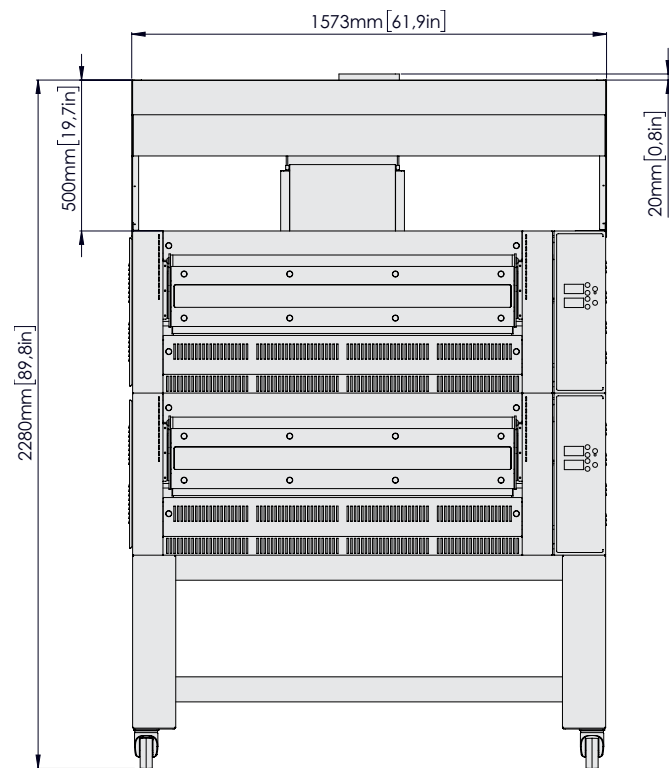

model	
 KGR635L	73 kg [161 lb]
 KGR635L	1680x1370x420 mm [66.14x53.94x16.54 in.] 165 kg [363.7 lb]

Giorgione KGR635L hood technical data | hood + double oven

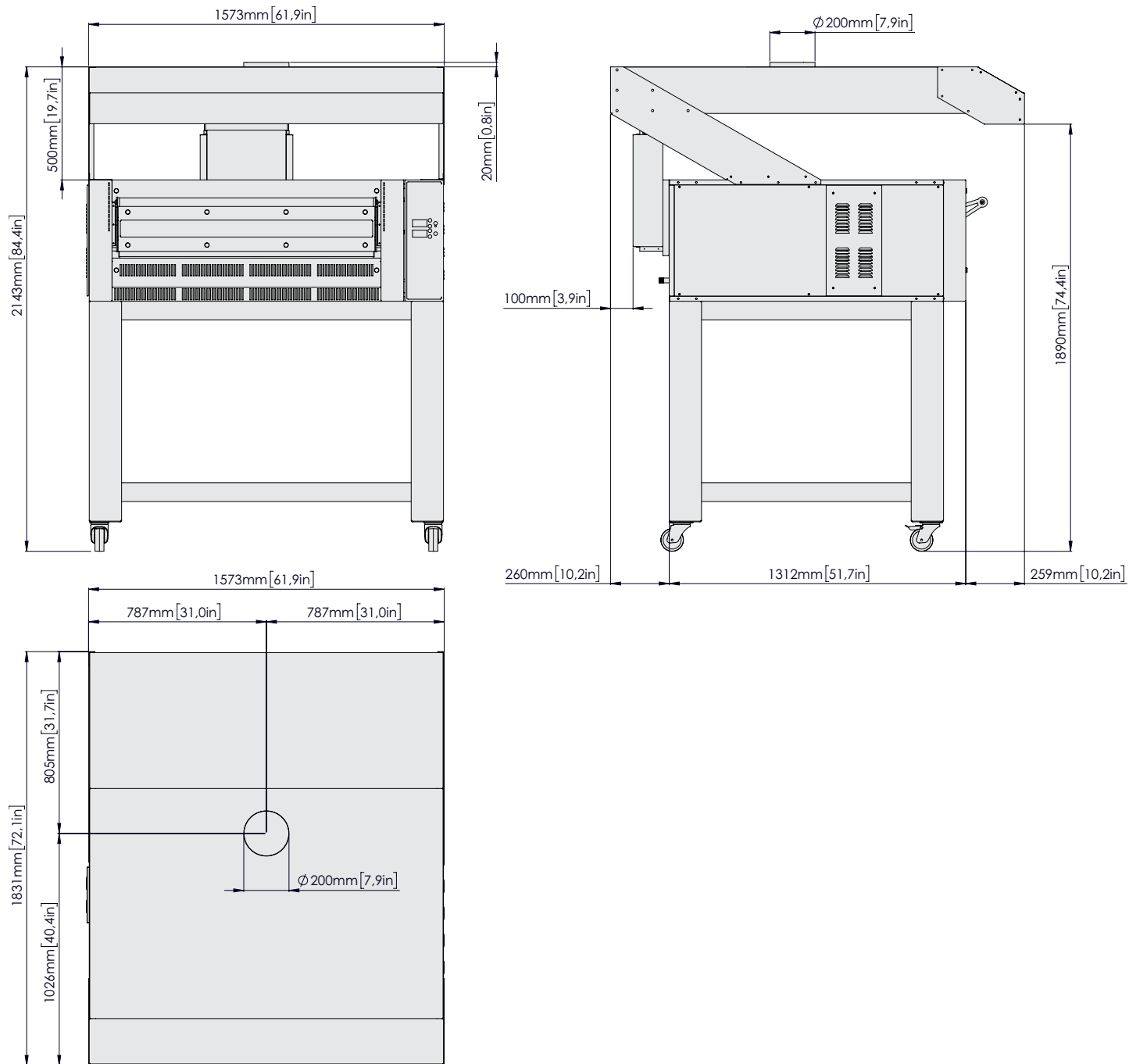

Giorgione KGR935 hood technical data | hood + single oven



model	
	KGR935 80 kg [176.3 lb]
	KGR935 1660x1730x420 mm [65.35x68.11x16.54 in.] 190 kg [418.9 lb]

Giorgione KGR935 hood technical data | hood + double oven

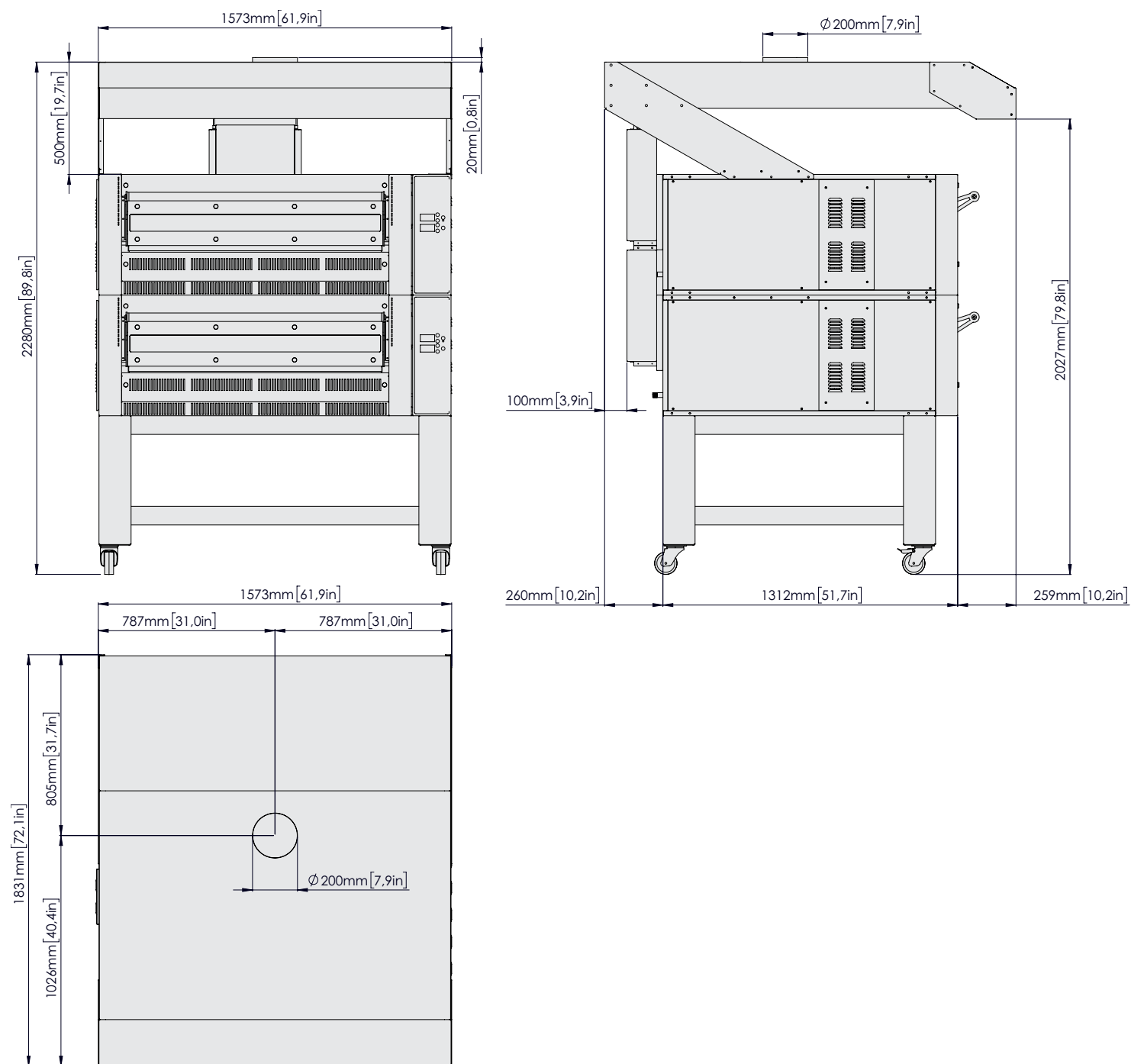

Safety instructions

- Read this guide carefully before installing the appliance, and keep it with care in an accessible place for any future consultation by the various operators.
- Moreover, the manual must always accompany the product through its life, even in case of transfer.
- Before any movement or installation, check that the room is suitable and systems comply with the installation country standards and the specifications indicated on the appliance rating plate.
- All installation, assembly and non-routine maintenance operations must be performed exclusively by qualified technicians that are authorised by the Dealer, in compliance with the regulations in force in the user country, and with the regulations on systems and work safety.
- Unauthorised actions, tampering or modifications that do not follow the information provided in this manual can cause damages, injuries or fatal accidents and null and void the warranty.
- It is forbidden to install the hood in environments at risk of explosion.
- Installation or maintenance that fails to comply with the instructions in this manual may cause damage, injury or fatal accidents.
- Persons not involved with the appliance installation may not pass through or stand in the work area during appliance assembly.
- The serial plate provides important technical information. This is vital in case of a request for maintenance or repair of the equipment: please do not remove, damage or modify it.
- Failure to follow these regulations may cause damage or even fatal injury, subsequently invalidating the guarantee and relieving the Manufacturer of all liability.

Symbols used in the manual and on the labels applied to the machine



Indicates that caution is required when performing an operation described in a paragraph that bears this symbol. The symbol also indicates that maximum operator awareness is required in order to avoid unwanted or dangerous consequences



Reference to another chapter where the subject is dealt with in more detail.



Manufacturer's tip



Indicates that the surfaces marked with this symbol may be hot and must therefore be touched carefully



Dangerous voltage



The symbol identifies the terminals which, connected to each other, carry the various parts of a device or system to the same potential (not necessarily the earth potential)



Indicates that it is necessary to read carefully the paragraph marked with this symbol before installing, using and maintaining the equipment

The company cannot be held liable for any print or transcription errors, reserving the right to make changes where deemed suitable without prior notice.

Partial reproduction without the Manufacturer's consent is prohibited. Measurements are purely indicative and not binding. The original language used to prepare this manual is English: the Manufacturer is not responsible for any translation/interpretation or print errors.

Transport

► Fig. 5

Fitted with personal protection equipment, transport the appliance to the installation location.

Use suitable equipment, capable of dealing with its weight: persons not involved with the appliance installation may not pass through or stand in the work area during the appliance assembly.

During the transport, pay particular attention to passing through openings and/or doors.

Preliminary operations

► Fig. 6

Carefully remove the protective film.

If any glue residue is left on the surfaces, remove it with soapy water but without any corrosive or abrasive products or sharp or pointed instruments.



Check that all the parts making up the hood are in good condition and without any faults or breakages, if that is not the case, contact the Dealer for the procedures to follow.

Assembling the hood

► Fig. 7

The hood arrives disassembled in several components that the installer must assemble following the directions in the figures from ► Fig. 8 to ► Fig. 11)

The fixing screws and the Allen screws required for assembly are contained in the bag supplied with the oven.

Fig. 5

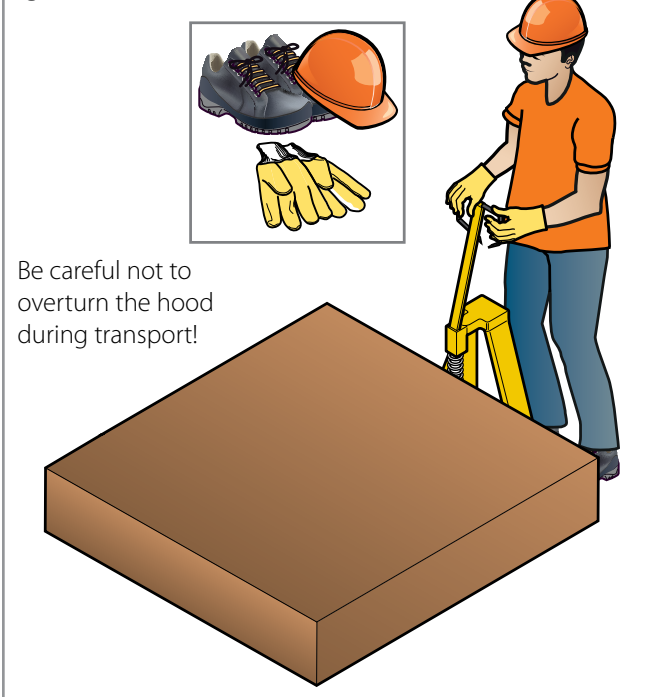

Fig. 6

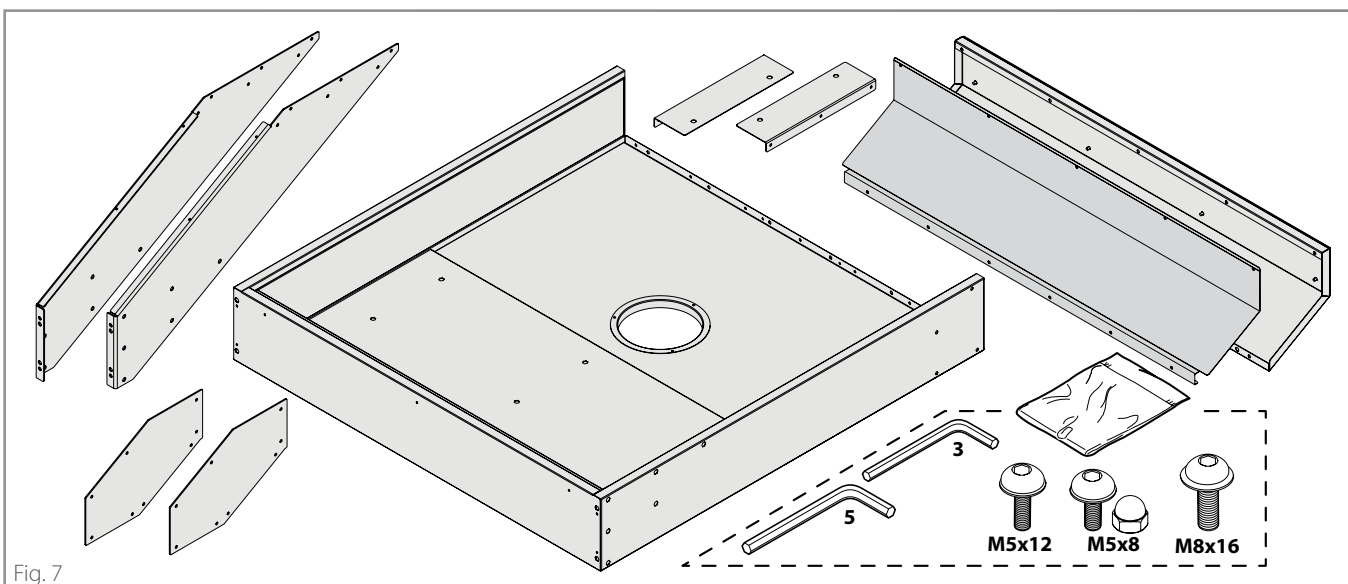
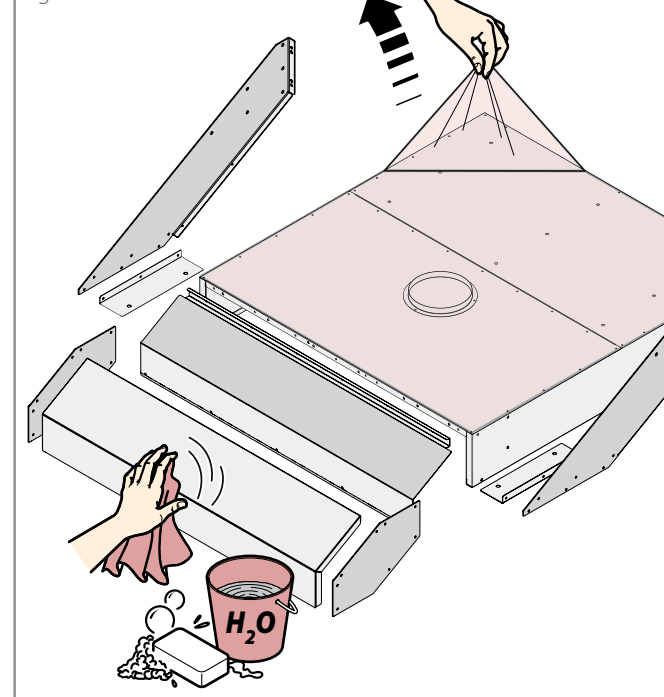

Fig. 7

Fig. 8

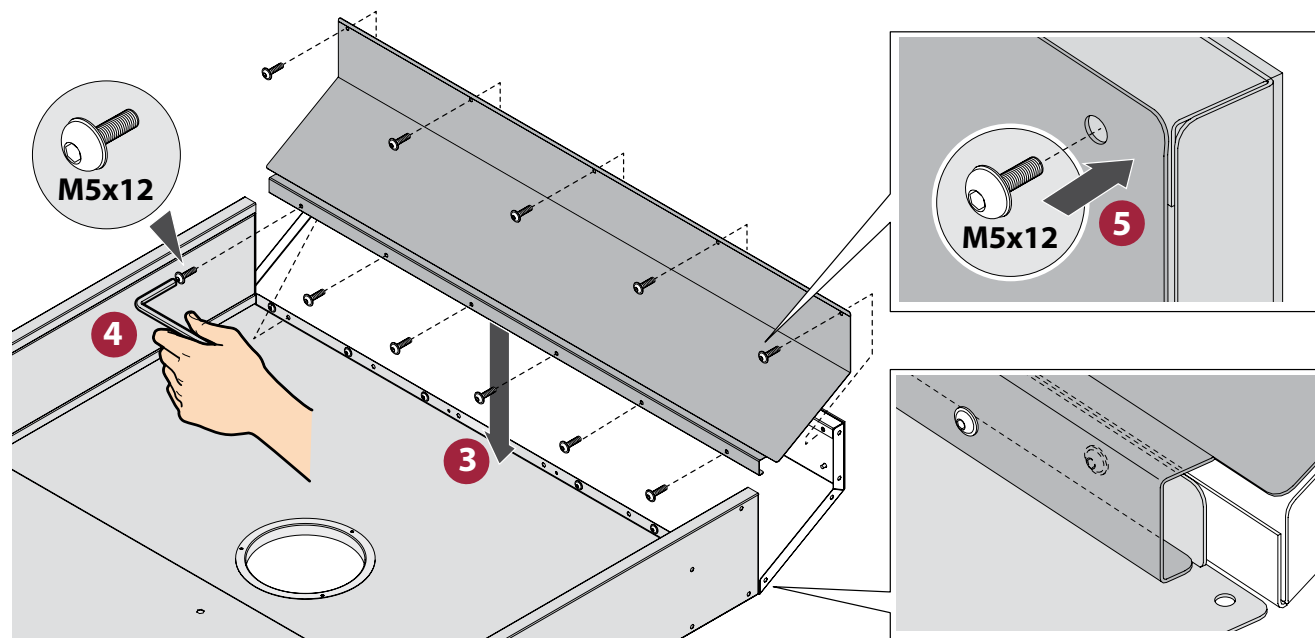
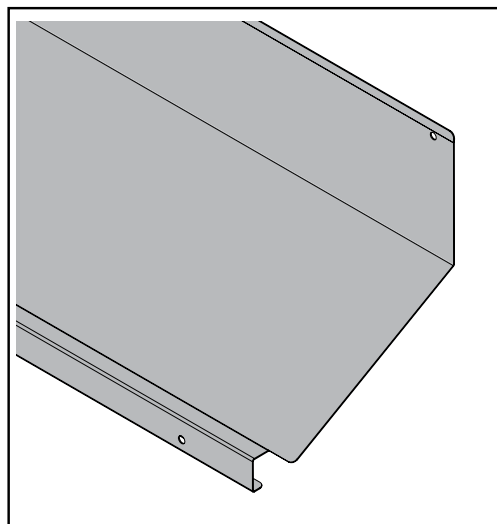
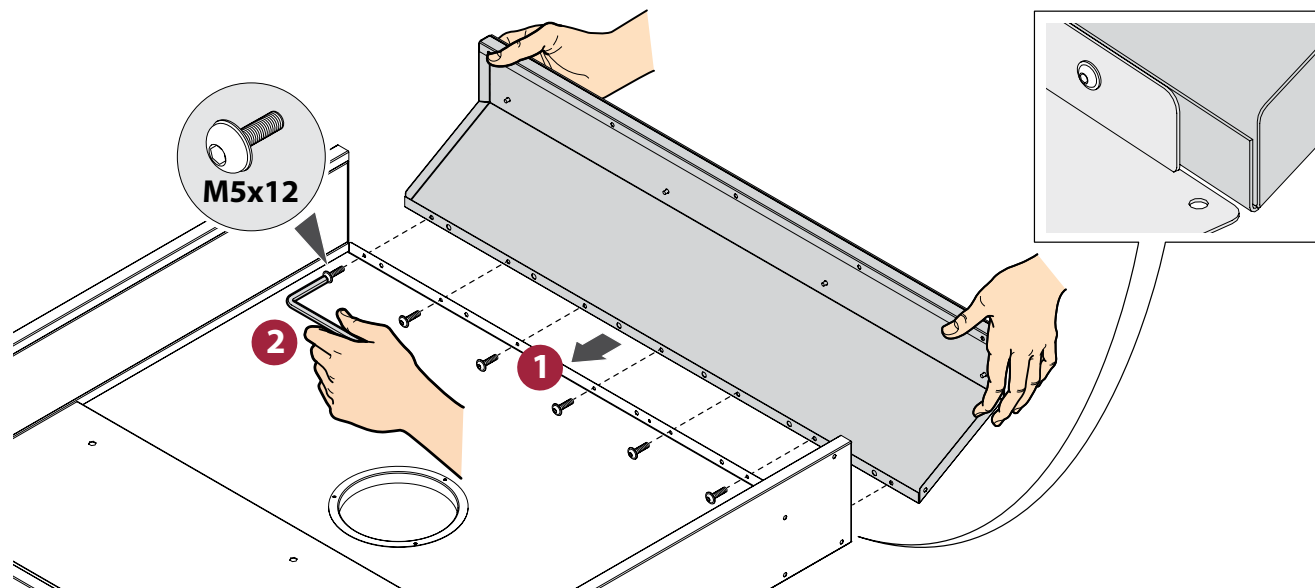
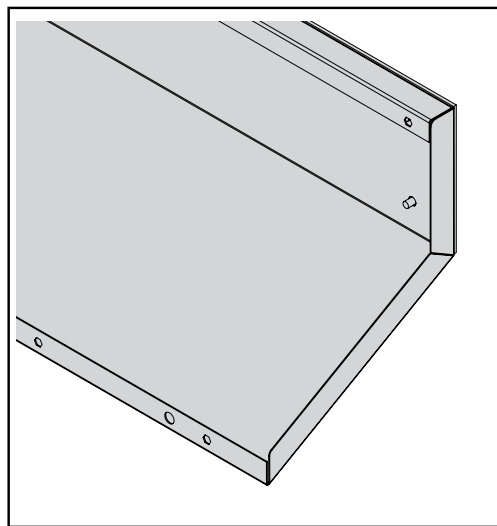

Fig. 9

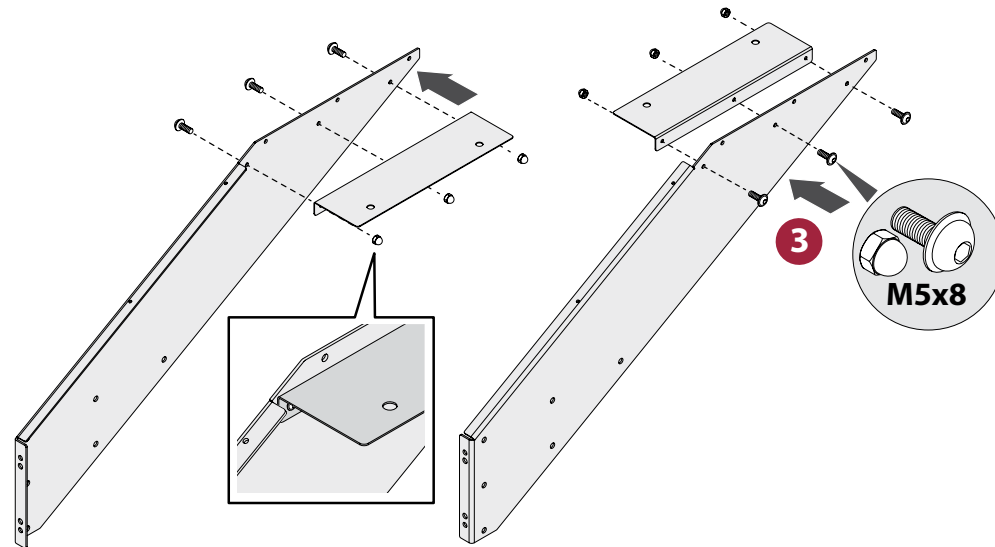
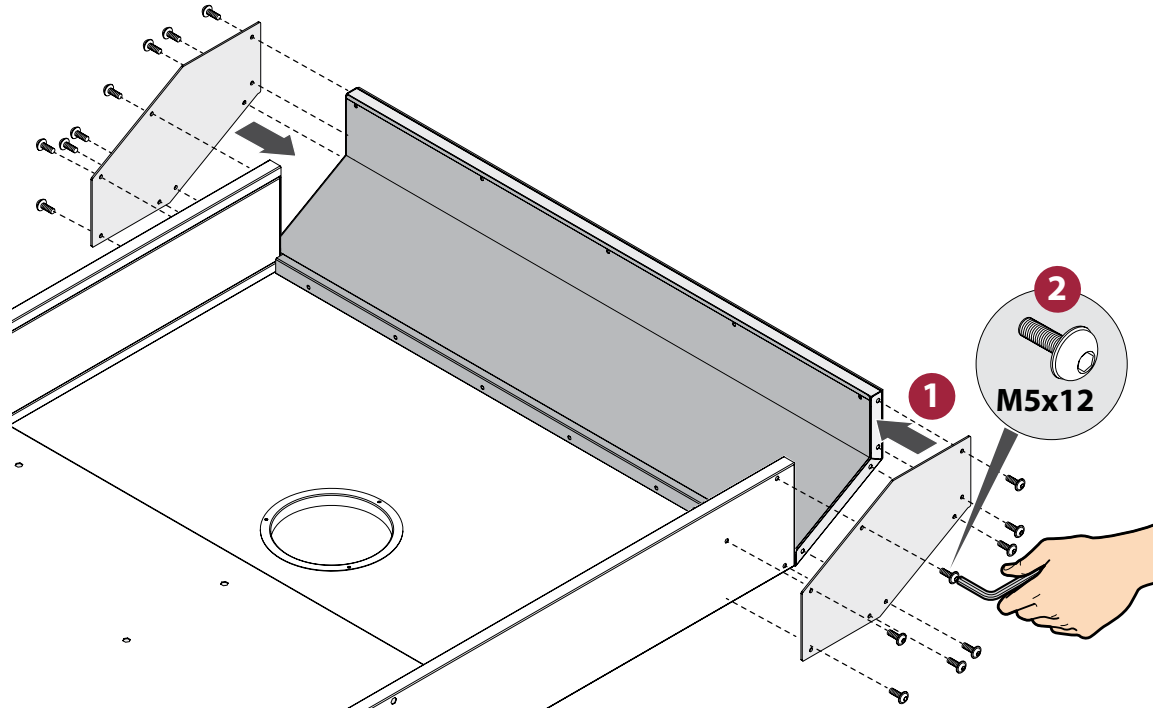
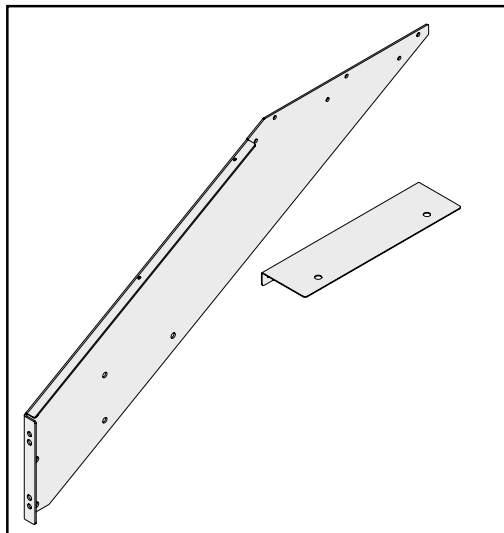
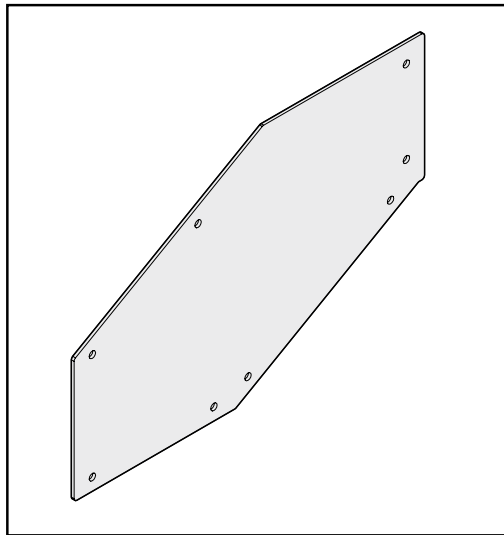

Fig. 10

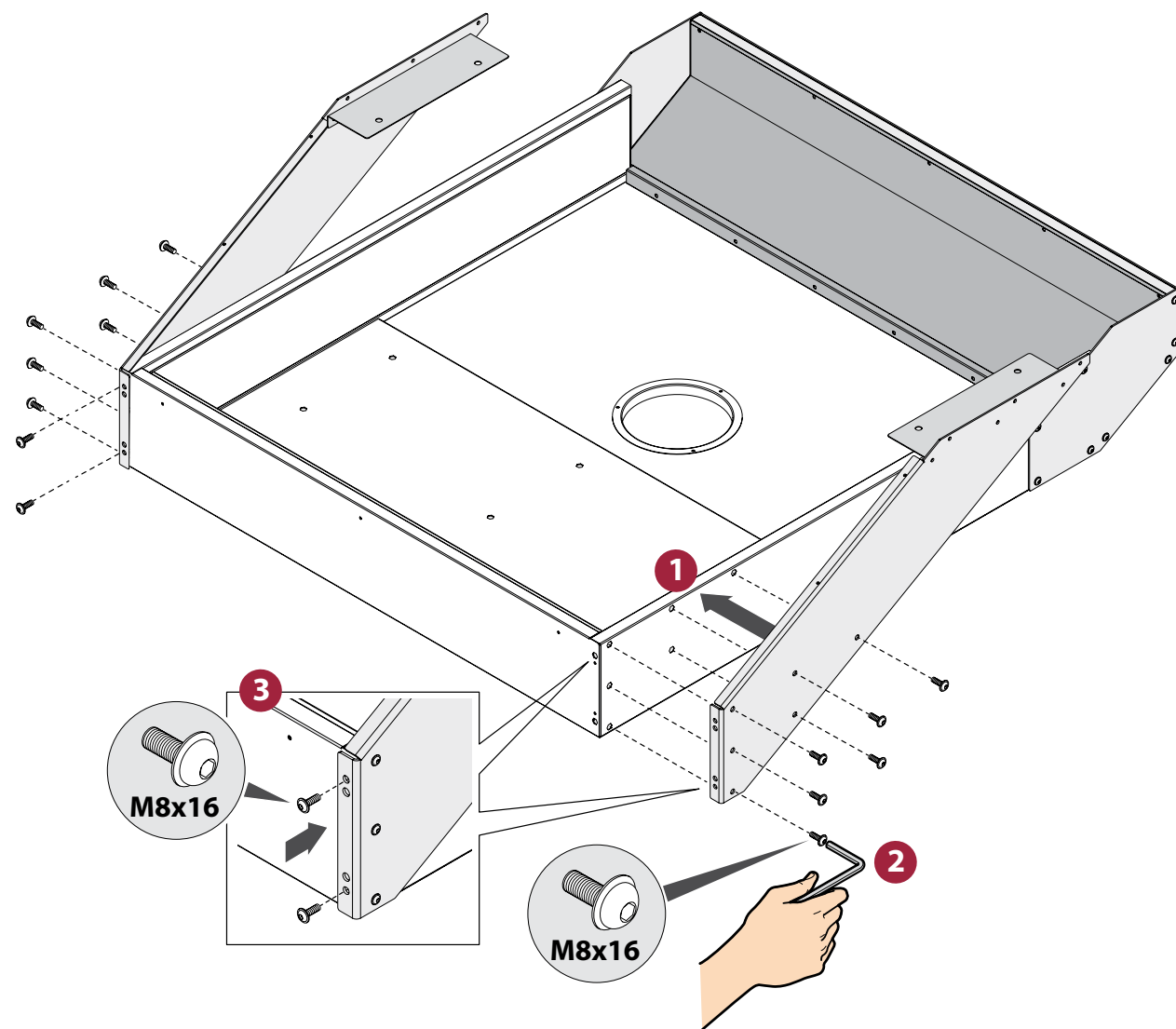
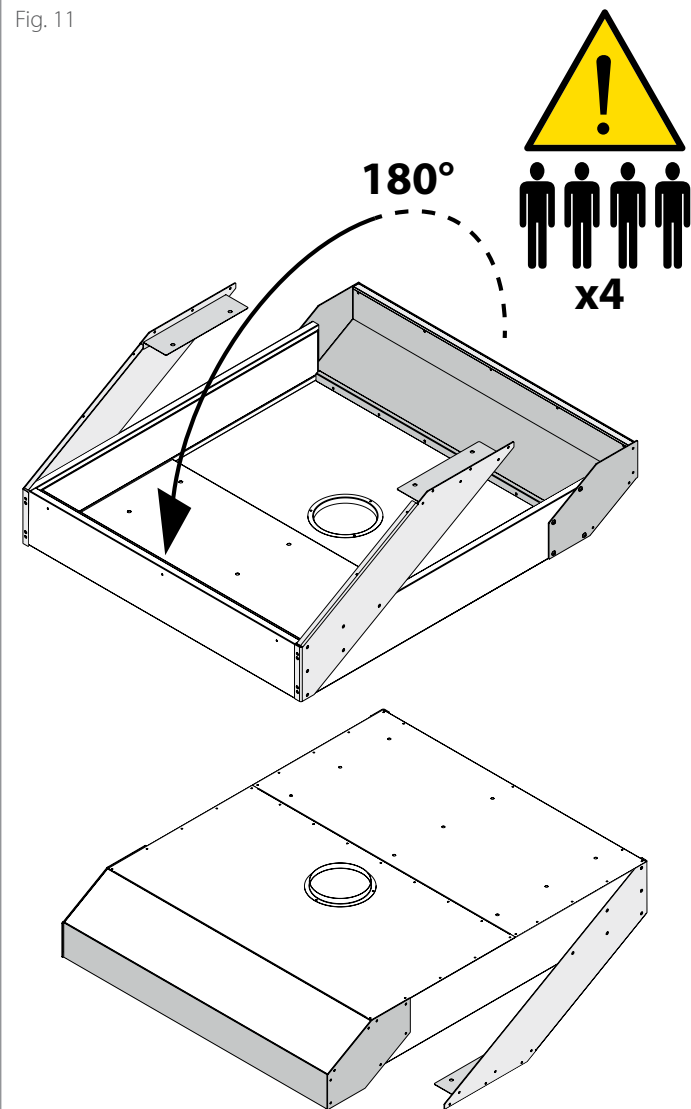



Fig. 11



Turn the hood upside down; the manoeuvre must be carried out by FOUR people equipped with personal protective equipment (e.g. gloves and safety shoes)

Positioning and connection to the oven below

 The hoods can be positioned **only** over a Giorgione Gas oven.
Assembly must be carried out by a minimum of FOUR people because of the dimensions and weight of the hood.

► Fig. 12

Disconnect the power supply from the oven to which the hood will be connected.
Fix the hood to the oven below acting as shown in the figure.

► Fig. 13

Make sure there is a distance of about **600 mm [24"]** from the ceiling (shorter distances could damage ceilings made of particularly delicate and heat sensitive materials - e.g. wood);

Fig. 13

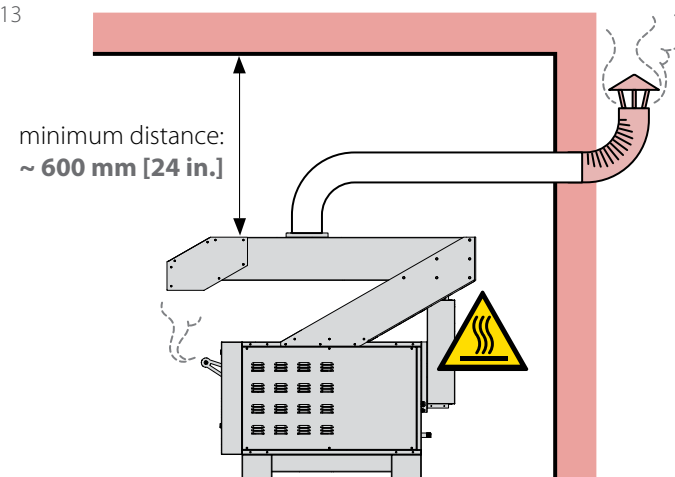
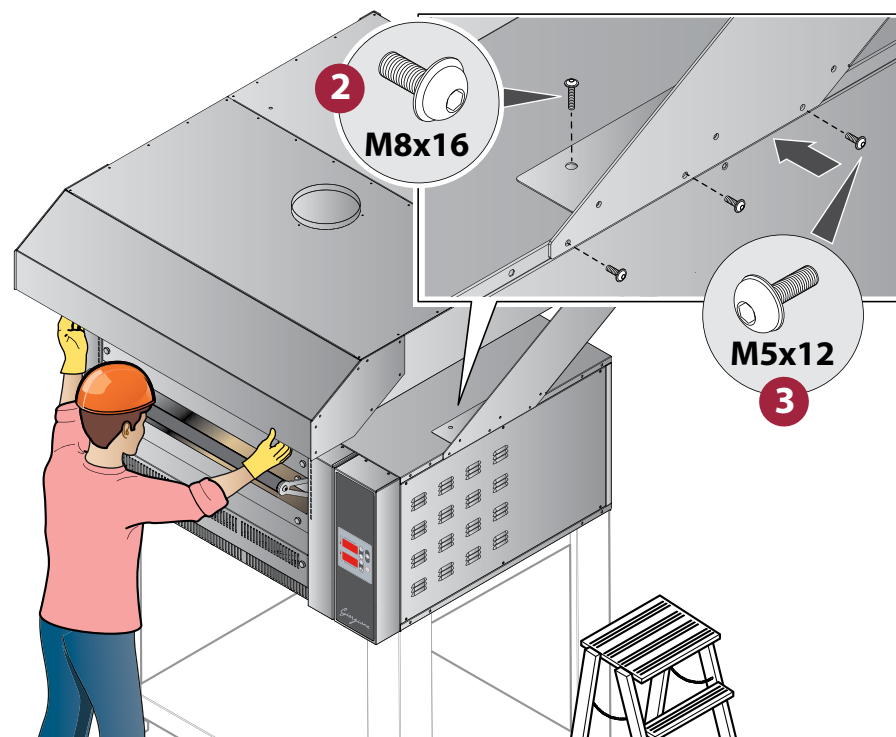

Fig. 12



Serial number plate reading

► Fig. 7

The serial number is on the back of the appliance. It provides important technical information that is vital in case of a request for maintenance or repair of the appliance: please do not remove, damage or modify it.

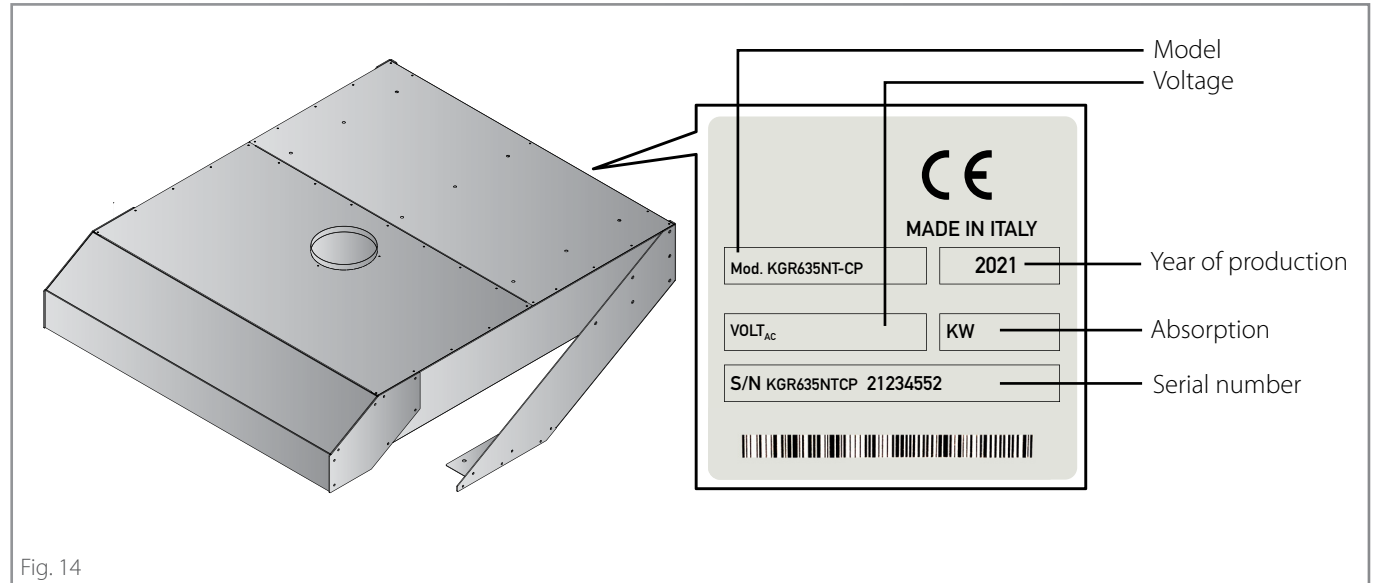

Smoke extraction

The oven is fitted with a flue in the back to get rid of the steam from the cooking chamber and the flue gas.

The gas from the cooking chamber and from the door opening can be conveyed outside through the manufacturer's hood (under-hood type).

Using metal clamps (not supplied), connect to it a Ø200mm [Ø7.87in.] flue tube (not supplied). The flue tube must be for the exclusive use of the equipment, in stainless steel resistant to high temperatures and must comply with current regulations.

The hood is not equipped with a suction motor, however it is possible to connect it to a **suitable user suction system** (the extractor, the flue tube and the clamps are NOT supplied by the manufacturer).

► Fig. 15

Using metal clamps (B) (not supplied), connect a flue tube (A) measuring Ø200mm [Ø7.87in.] (to ensure correct draft up to a maximum of 20 linear meters [787.4 in.], three curves and a terminal on the roof).

The flue tube must be for the exclusive use of the equipment, in stainless steel resistant to high temperatures and must comply with current regulations.

The hood is not equipped with a suction motor, however it is possible to connect it to a **suitable user suction system** (the extractor, the flue tube and the clamps are NOT supplied by the manufacturer).



Provide a condensate drain (not supplied) to permit normal control and draining operations.

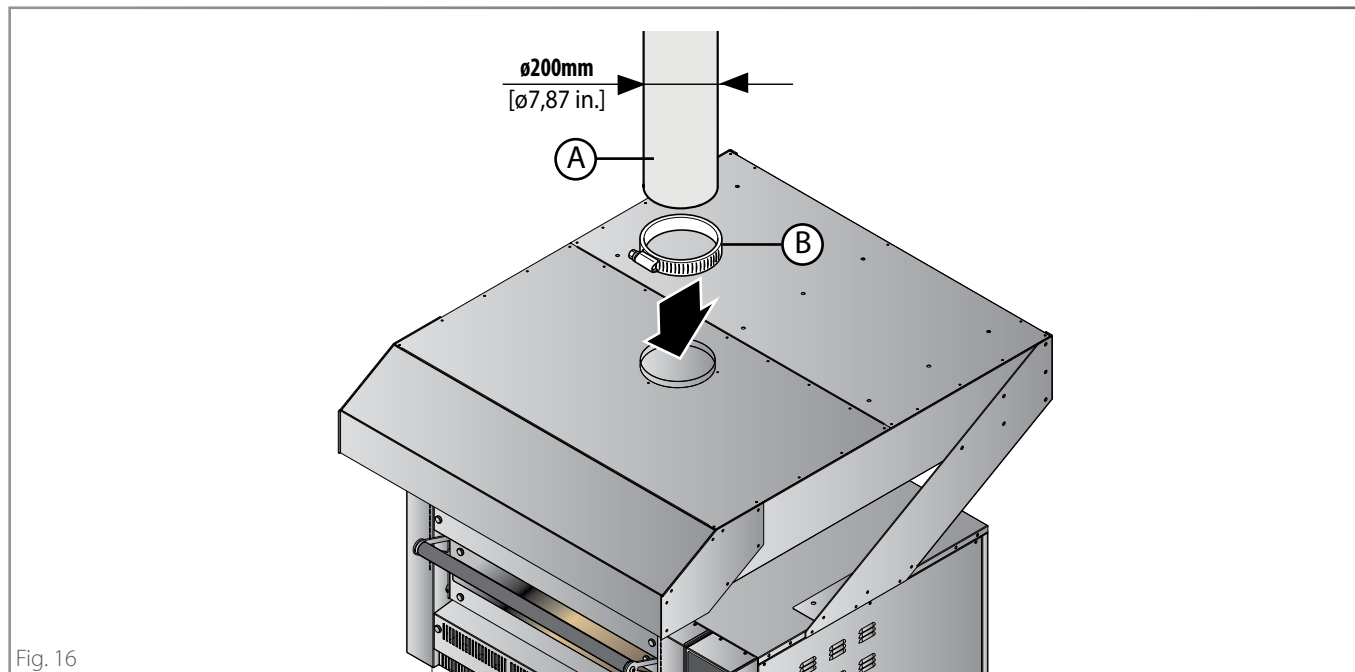

Fig. 16

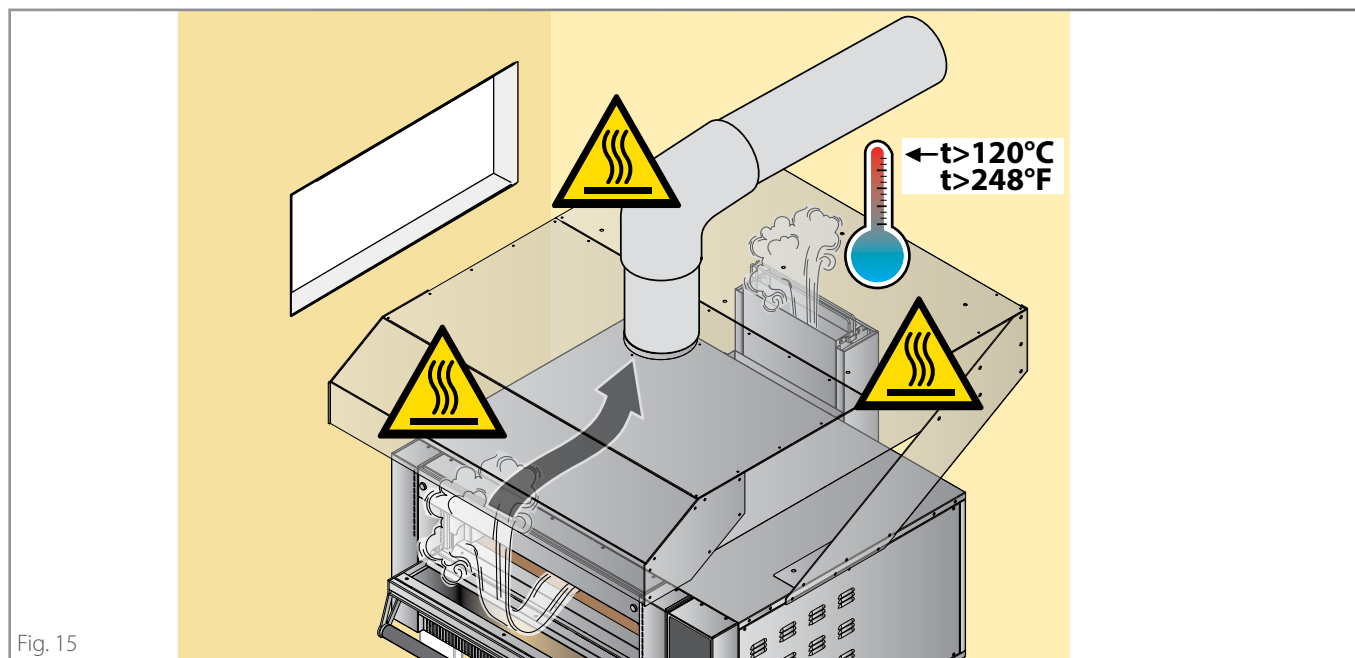

Fig. 15

Pre-testing and final inspection

Before delivery to the customer, the hood is checked and tested in the Manufacturer's factories.

The "production process check sheet" enclosed with it guarantees that **each** step in the production process, from assembly to packaging, was carefully checked from both the operating and safety standpoints.

After installing the appliance, check and mark with a "✓" all the boxes of the table on the side: this will confirm the installation is complete and correct.

Finish off explaining to the user how to use the appliance in an optimal and safe way and how to carry out ordinary maintenance and cleaning.

✓	Positioning checks	Reference chapter on page...
	Has the protective film been removed from the surfaces?	<u>Preliminary operations</u> on page 14
	Is the equipment perfectly bound to the underlying oven?	<u>Positioning and connection to the oven below</u> on page 18
	Is the current chimney flue adequate and does it comply with the current regulations?	<u>Smoke extraction</u> on page 20
✓	Miscellaneous	Reference chapter
	Does the user have all the documentation relative to the hood?	-
	Has the user been correctly trained on the use and maintenance of the hood?	-

The company cannot be held liable for any print or transcription errors, reserving the right to make changes where deemed suitable without prior notice.

Partial reproduction without the Manufacturer's consent is prohibited. Measurements are purely indicative and not binding.

The original language used to prepare this manual is English: the Manufacturer is not responsible for any translation/interpretation or print errors.

CUPPONE 1963

Cuppone F.lli S.r.l.

Via Sile, 36

31057 Silea (TV) - ITALY

T +39 0422 361143

F +39 0422 360993

info@cuppone.com - www.cuppone.com

